

PLANAR CORES

Many next generation electronics equipment will use switched mode power supplies where the voltage transformation unit is integrated on a circuit card. As cards may be racked with minimal clearances, low profile components are necessary. Planar assemblies differ radically from conventional transformers as wire windings are replaced by stacks or flat spiral laminations. In some cases the winding can be replaced by printing circuit tracks, with the E core inserted through the board. The planar E core's low profile shape and ease of construction offers significant advantages including: Fast error-free winding; excellent heat sinking properties and efficient repeatable performance at low cost.

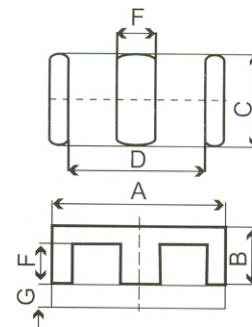

Part No.	Core	A mm	B mm	C mm	D mm	E mm	F mm	G mm	Effective Parameters			F44	F48	F47
									le mm	Ae mm ²	Ve mm ³			
32-9140-	EE14x3.5x5	14 _{±0.3}	3.5 _{±0.1}	4.9 _{±0.2}	11 _{±0.25}	2.9 _{±0.15}	2.05 _{±0.15}	-	20.70	14.50	300	-	-	1100 _{±25%}
32/33-9140-	E+I 14	14 _{±0.3}	-	4.9 _{±0.2}	-	-	-	1.50 _{±0.05}	16.70	14.50	240	-	-	1300 _{±25%}
32-9180-	EE18x4x10	18 _{±0.35}	4 _{±0.10}	10 _{±0.2}	14 _{±0.3}	3.95 _{±0.15}	2.05 _{±0.15}	-	24.30	39.50	960	-	-	2700 _{±25%}
32/33-9180-	E+I18	18 _{±0.35}	-	10 _{±0.2}	-	-	-	2.0 _{±0.1}	20.30	39.50	800	-	2900/R	3100 _{±25%}
32-9210-	EE22x5.7x15.8	21.8 _{±0.4}	5.7 _{±0.1}	15.8 _{±0.3}	16.8 _{±0.4}	4.9 _{±0.2}	3.20 _{±0.1}	-	32.50	78.50	2550	-	-	4300 _{±25%}
32/33-9210-	E+I22	21.8 _{±0.4}	-	15.8 _{±0.3}	-	-	-	2.5 _{±0.05}	26.1	78.50	2040	-	-	5000 _{±25%}
32-9320-	EE31.8x6.3x20.3	31.75 _{±0.64}	6.35 _{±0.13}	20.32 _{±0.41}	25.4 _{±0.5}	6.28 _{±0.2}	3.23 _{±0.15}	-	41.70	129	5380	6425 _{±25%}	-	5900 _{±25%}
32/33-9320-	E+I31.8	31.75 _{±0.64}	-	20.32 _{±0.41}	-	-	-	3.18 _{±0.13}	35.90	129	4560	7350 _{±25%}	-	6780 _{±25%}
32-9380-	EE38.1x8.26x25.4	38.1 _{±0.76}	8.26 _{±0.13}	25.4 _{±0.51}	30.85 _{±0.6}	7.6 _{±0.2}	4.52 _{±0.2}	-	52.60	194	10200	7940 _{±25%}	-	7250 _{±25%}
32/33-9380-	E+I38.1	38.1 _{±0.76}	-	25.4 _{±0.51}	-	-	-	3.81 _{±0.13}	43.70	194	8460	9290 _{±25%}	-	8500 _{±25%}
32-9640-	EE63.8x10.2x50.3	63.8 _{±1.3}	10.2 _{±0.13}	50.3 _{±1}	53.6 _{±1.1}	10.2 _{±0.2}	5.17 _{±0.2}	-	79.70	511	40700	13300 _{±25%}	-	12720 _{±25%}
32/33-9640-	E+I63.8	63.8 _{±1.3}	-	50.3 _{±1}	-	-	-	5.08 _{±0.13}	69.60	511	35500	15050 _{±25%}	-	14360 _{±25%}

❖All above Cores available in clipped version for clamping purpose.